

COPPER RACK GROUND BAR

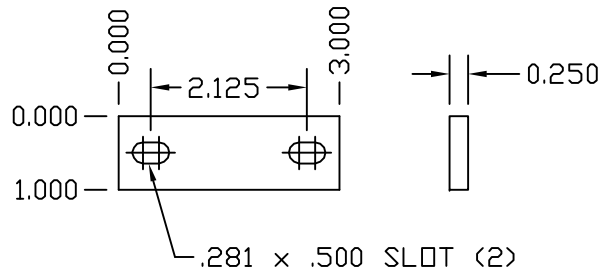

SPLICE PLATE

- KIT INCLUDES:
- (2)-12-24 X 3/4" CU. MACHINE SCREW
  - (2)-#12 CU. FLAT WASHER
  - (8)-#6-32 X 1/4" CU. MACHINE SCREW
  - (8)-#6 RING TERMINAL

HWKITPTS (1)

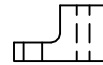

11/16WINS (2)



SMS0126SHWZ (2)

TINNED COPPER RACK  
GROUND BAR KIT

EST WT 3#

APPROVED

AS DRAWN: \_\_\_\_\_  
 AS NOTED: \_\_\_\_\_  
 DATE: \_\_\_\_\_

THIS DOCUMENT AND THE CONTENTS THEREOF IS THE PROPERTY OF HARGER INC., AND IS FURNISHED TO YOU FOR INFORMATION ONLY. THE INFORMATION CONTAINED HEREIN IS CONFIDENTIAL AND OF A PROPRIETARY NATURE AND MUST NOT BE DISCLOSED TO THIRD PARTIES WITHOUT THE EXPRESS WRITTEN APPROVAL OF HARGER INC.

LET	REVISION	DATE	BY

TOLERANCES UNLESS NOTED:  
 FRACTIONAL +/- 1/16  
 DECIMAL +/- .030  
 BREAK SHARP EDGES

3RD ANGLE PROJECTION

PART NO. TRGBHKIT14119.25  
 RACK GROUND BAR KIT

DRAWN BY:  
LAL  
 CHECKED BY:  
-  
 DATE:  
071516

**HARGER**  
 301 ZIEGLER DRIVE  
 GRAYSLAKE, IL 60030  
 (847) 548-8700

REVISION:  
-  
 SCALE:  
3/8  
 SHEET:  
1 OF 1